



AeroFlow® FlexiSmart

Heating panel

General Information

1. Safety instructions

information listed here carefully. Store these instructions in a safe place and pass them on to the following user/owner if necessary. The electronic heating you have just purchased is only suitable for heating inside enclosed rooms. Damaged devices (e.g. damaged connecting cables) must not be operated.

Our radiators are tested according to the applicable IP protection class when properly installed (International Protection Code – in this case: Protected against spray water). In the fixed electrical installation, a separating device with at least a 3mm contact opening shall be provided on each pole (for example, a safety device, residual current circuit breaker). Substances which are prone to ignition or thermal decomposition (e.g., adhesives of floor coverings) may only be used if it is certain the heater has been cooled to room temperature. The heater must not be placed directly below a wall socket.

The radiator is not intended to be used by persons (including children) with limited perceptual abilities or by people with lack of experience and / or lack of knowledge of using it. Unless they are supervised by a person responsible for their safety or have received instructions from this person on how to use the radiator. Children should be supervised to ensure that they do not play with the radiator.

2. Electrical connection

Your AeroFlow® electric radiator system is suitable for fixed connection to wall sockets or operation from power sockets. An electrician must be consulted when installing it via a wall socket. If the mains connection cable of the radiator is damaged, it needs to be replaced by us or a suitably qualified electrician in order to prevent danger and additional damage.

The radiator may only be operated with a thermostat directly on the radiator or with an external control. The heating control must always be performed using a suitable room thermostat.

3. Installation

Our devices are mounted horizontally on the wall. Attachment to the ceiling is not permitted. The radiator should normally be installed under a window or on an external wall. Please ensure that the radiator can radiate into the room as freely as possible. You can find our detailed installation information on Page 7.

4. Heating

thermostat. A higher setting means a longer operating time on the radiator. Please refer to the operating instructions of the room thermostat on the following pages. It is possible that a slight odour can develop during initial commissioning, since some materials still have to be baked out. This does not pose any threat, and it will run off completely after a period of time. Please ventilate the rooms well if necessary. In rare cases, noise can occur in the form of cracking, which is caused by heat-induced material movements, which are harmless.

5. Overheating protection

For your safety, the heater is equipped with a temperature switch integrated in the heating system. If the radiator is not heated in the permitted manner (e.g. by covering or blocking) the radiator switches off automatically. The covering of the heater (e.g. through towels) during operation is not permissible, it is a fire hazard! Any resulting defects on a temperature switch and the resulting costs for the repair shall be borne exclusively by the party causing the damage. We can offer you a towel rack suitable for our radiators in our online shop.

6. Malfunctions

If the radiator does not emit any heat, please check that the thermostat is preset to the desired temperature. In addition, it is essential to check that the local power distribution is switched on or that the fuse is in working order. If you encounter such malfunctions, please contact your installer. In the event of a complaint being addressed to us, the serial number of the device is required for order processing. You will find this information on the rating plate.



7. Cleaning of device

Switch the radiator off before each cleaning sequence and allow it completely cool down. Only wipe the radiator off with a soft, damp cloth and do not use any chemical detergents or abrasive milk. A correspondingly designed cleaning brush can be used for the cleaning of the slats (not included). We offer you an appropriate product in our on-line shop for purchase in the accessories section.

8. Directions for disposal

The devices marked with the symbol below must not be disposed of with household waste. As a manufacturer, we are responsible for the environmentally sound treatment and recycling of WEEE as part of our production responsibility. Please contact your local authority for further information on collection and disposal.



Guarantee conditions

For this product, we provide a 30-year warranty on the area of heat generation and usability of the basic unit as well as a 2-year warranty on the control technology, the spare parts and the accessories. In other respects that statutory warranty shall apply. Our warranty conditions regulate the additional warranty claims, which are in addition to the statutory warranty claims of the customer.

The warranty conditions apply only to devices which are purchased by the end user as new devices. A guarantee obligation does not come about insofar as the final customer purchases a used device or for its part a new device from another end customer.

The warranty is provided if a manufacturing and/or material fault occurs during the warranty period on our radiators and the accessories. Within the warranty period that commences upon the delivery date, we will remedy free of charge any malfunctions that are demonstrably due to a material defect or defective performance.

Our guarantee includes the free exchange of defective parts as well as the provision of free spare parts during the warranty period. We are only liable if the function of the radiator is impaired and the defect is not caused by negligent, intentional or improper handling, use of force, transport,

misuse, connection to incorrect mains voltages, failure to observe the appropriate operating instructions or installation instructions, improper cleaning or corrosion damage due to caustic water, by chemical and / or electrochemical effects or by normal wear and tear.

The warranty will become void if the unit has been subjected to interventions or attempted repairs by persons who have not been authorised to do so by us. Please note that dismantling of the heater by the customer or third parties is fundamentally not permissible. If there is a violation this warranty entitlement shall cease to apply.

The possible replacement of the radiator side part (e.g. when changing the control technology) and / or the possible shortening of the connecting cable (e.g. removal of the earthed plug for the purpose of producing a fixed connection) does not lead to a loss of warranty, insofar as no intervention in or manipulation of electronic components takes place, beyond the necessary extent of the modification to be performed, and the correspondingly permissible work is performed by a qualified expert.

The warranty covers the careful inspection of the radiator or the accessories whereby it must be initially determined whether a warranty claim applies. In the event of a claim under the warranty we solely decide in which manner the fault shall be rectified. We are at liberty to replace a radiator or accessory or to perform a repair. During the warranty period, we assume all material, assembly and transport costs within the scope of this warranty.

In addition to the above-mentioned warranty service, the end customer cannot assert any claims for indirect damage or consequential damage caused by the device, in particular for compensation for damages incurred outside the device. Statutory claims of the customer against us shall remain unaffected by this clause. Warranty claims must be reported to us before expiry of the warranty period, within one week of the defect being detected. For this purpose, please use the „Warranty Certificate“ attached to this manual and, after having filled it in, send it to us by post to the stated address or an electronic form by e-mail to our e-mail address mentioned above.

Manual on assembly of wall bracket

Only the wall bracket supplied may be used for wall mounting! The latest regulations according to VDE 0100 part 701 must be complied with for the installation and operation in damp rooms. The device may not be mounted directly under a wall socket. In order to avoid excessive heat radiation upon the wall socket, a certain safety distance must also be taken into account between the radiator and the wall socket. This distance is largely determined by the material quality and heat resistance of the locally installed socket and therefore can not be assessed by us. We assume no liability for improper handling and possible damages resulting from this. In case of doubt, consult a specialist before installation. Suitable screws and dowels must be used depending on the type and condition of the wall material. When positioning the wall bracket and the heater, please always observe the stipulated minimum distances (see the following figures).

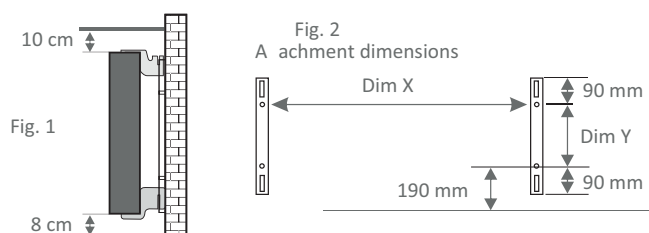

All radiators have four temperature-resistant holders, which guarantee optimum fixing of the heater. Please note the correct hanging position of the upper (marking 1) and lower (marking 2) holders on the heater (see following figures).

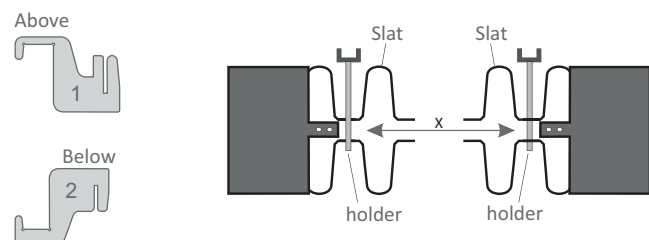

With the type-specific dimension table, you always obtain the correct positioning for the U-rails and the holders for the correct mounting and fixing of the radiator.

Radiator type	Dim X (mm)	Dim Y (mm)
MINI 650	232	405
MAXI 2450	1066	405
COMPACT 1300	466	405
SLIM 1200	766	120
MIDI 1950	766	405
SLIM 1600	1066	120
SLIM TALL 1600	232	1040

For the assembly please perform the following steps:

1. The two U-rails must be fixed to the wall whilst observing the minimum distances and depending on the type-specific X / Y-dimension.
2. The two holders marked with the marking 2 are to be inserted into the U-rails at the bottom.
3. Following this the radiator is hooked into the lower holders and tilted forward at an angle. Hold the radiator while doing so!
4. The two holders marked with the marking 1 are to be inserted into the U-rails at the top and temporarily pulled up.
5. Finally, place the radiator in a vertical position and press the upper holders down until the heater is completely fixed in place.

Alignment of the temperature sensor

The temperature sensor is attached to the bottom of the radiator in a clip. If, due to an placement of the device in a niche or corner, the room temperature and the measured temperature is influenced, it can be removed from it. The distance to the radiator can be increased by turning the connection cable of the sensor. The best way to correct the temperature is the menu „temperature correction“

Smart Start (adaptive start control)

With this function, the desired temperature is reached already at the start time of the program. This means that the heater is already heating before the set start time. This is not a malfunction! Smart Start can only be used in program



mode. You can deactivate Smart Start in the menu item "Programming". When the Smart Start is deactivated, the electric radiator starts heating when the set start time is reached.

Learning phase: In order to reach the target temperature exactly at the start time of each programmed time window, your FlexiSmart carries out a learning phase in the first seven days. During this time, heating is always started 15 minutes before the set start time (in every single time window).

As a result, the FlexiSmart controller learns how fast or slow heating takes place in the room and adjusts the „smart start time“ of heating. After the learning phase, the FlexiSmart controller decides when to start heating up. Your rooms will be heated up as effectively as possible.

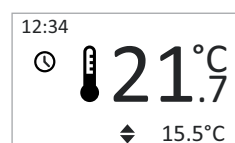

Status-Display

The first menu, you will see after switching your AeroFlow® heater. It shows the current time on the top left (for setting see page 14). The large display next to the thermometer icon shows the current room temperature. The small temperature in the lower right corner shows the target temperature.

Depending on the program setting, the following icons are visible:

- = The AeroFlow® heater is in program mode (see page 11).
- = Manual mode (program mode Off). The target temperature will be controlled via the arrow buttons.
- = The heater is heating. As soon as the heating elements do switch off, this symbol disappears.
- = Open window detected, the AeroFlow® heater is temporarily switched off.
- = Holiday Mode: The digit below the icon indicates the number of remaining holidays (see page 12).
- = Keylock/Childlock ON (to enable/disable press both arrow buttons simultaneously for min. 5 sec.).

NOTES:

If the clock symbol (program mode) is not displayed, lower or raise the target temperature by using the arrow buttons. The AeroFlow® heater will always hold this temperature.

In case the program mode is enabled (the clock symbol is displayed), the target temperature can also be lowered and raised with the arrow buttons. The manually set target temperature overrides the program mode until the next preset time frame. The AeroFlow® heater returns to programming mode after then.

To turn the heater off, keep the OK button pressed for min. 5 seconds. The "sleeping mode" will be displayed.

Temperature-Overview

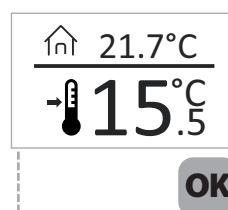

The display view changes after 5 seconds without pressing a button. The current temperature is displayed on top and the target temperature at bottom.

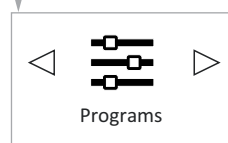

In this menu you will change (programming mode) or overview the heating times. You don't see this menu item?

Enable the programming mode in the main settings by switching "Programming" to "ON".

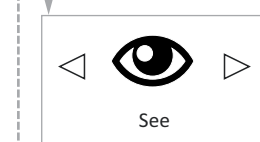

Select this menu if you want to view the heating plan. You can not make changes in this menu item.

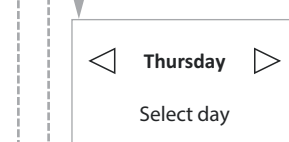

Select the day of the week for which you want to see the heating plan.

Start	End	Temp
00:00 → 08:00		11,0°C
08:00 → 16:00		19,0°C
16:00 → 00:00		11,0°C
--:-- → --:--		-- °C
--:-- → --:--		-- °C
--:-- → --:--		-- °C

See the heating plan on the chosen day. Press OK to exit the menu item display.

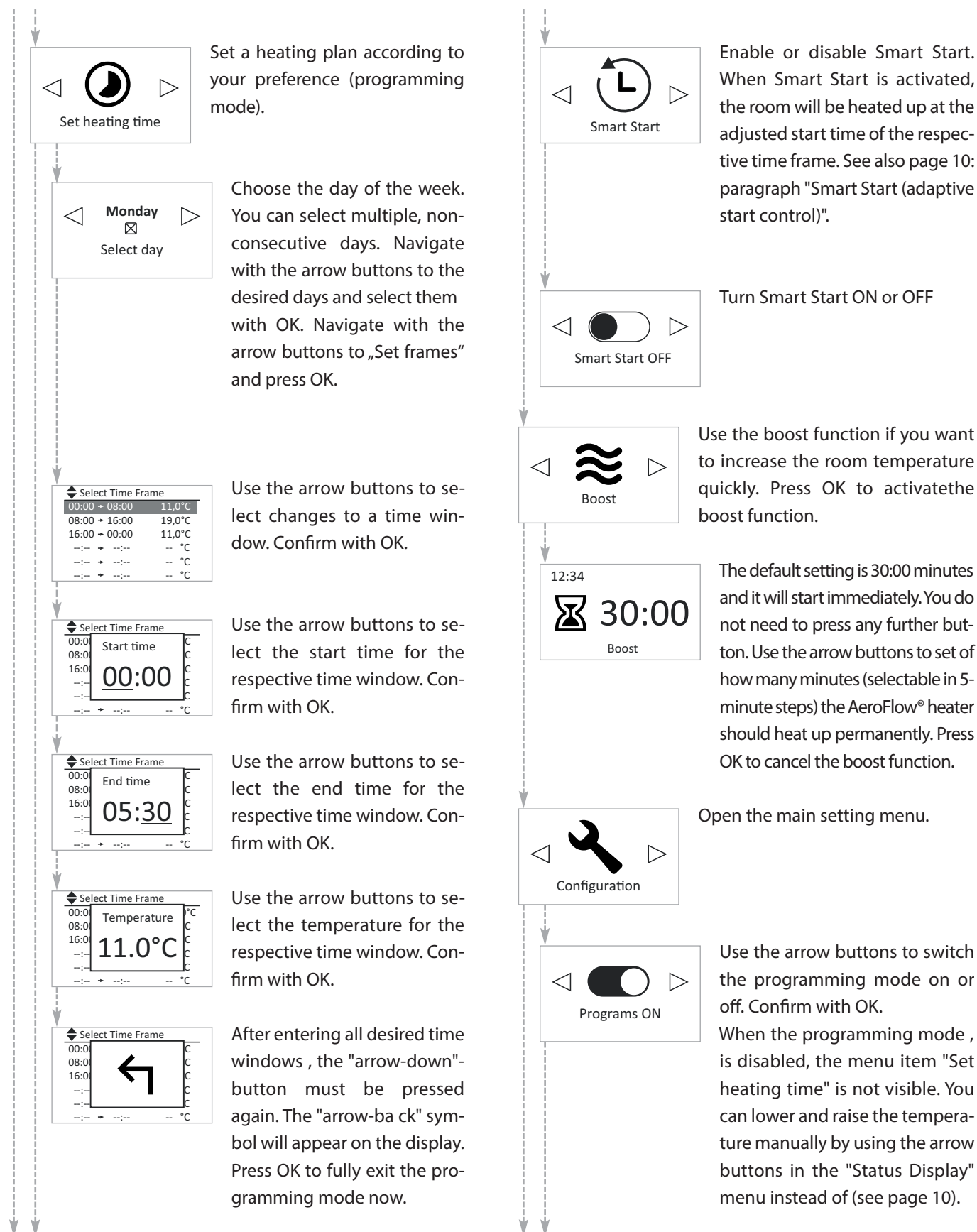

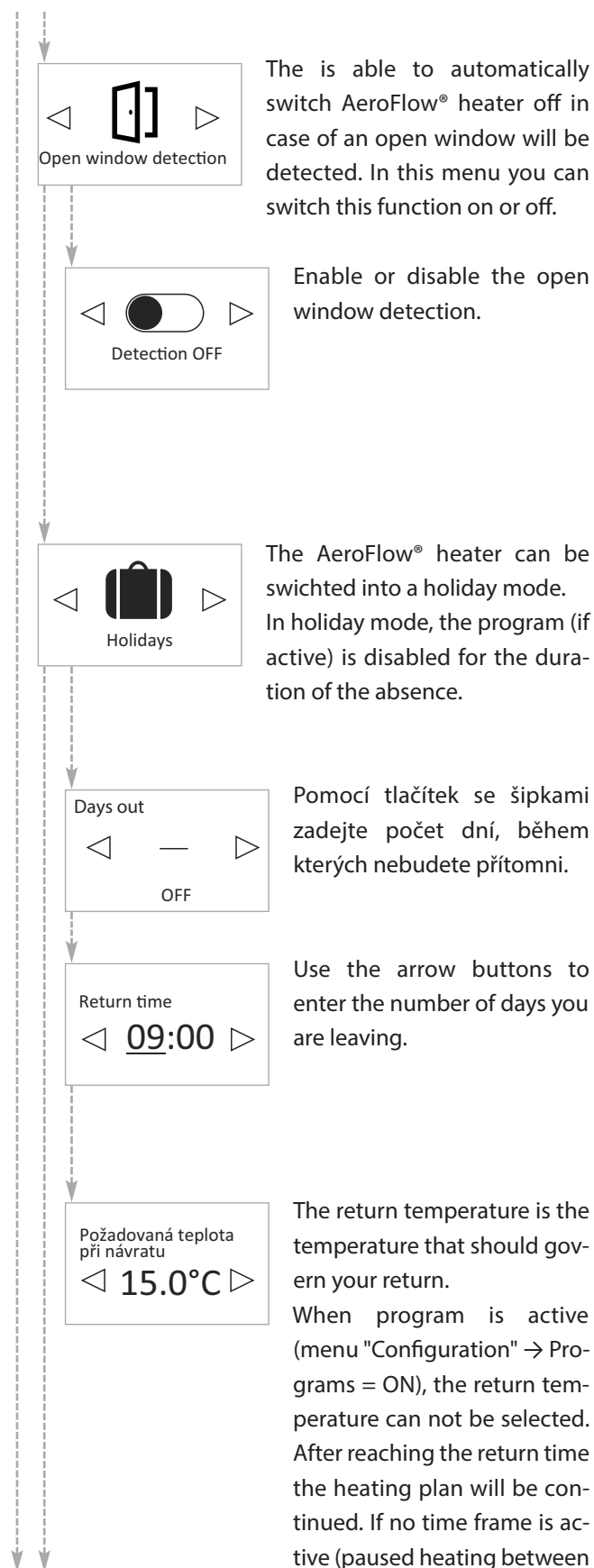

two time frames), the Antifreeze temperature is applied. So the heating plan continues as programmed.

If program is disabled, you can use the arrow keys to set the return temperature. Confirm with OK. The status display with the suitcase icon and the number of remaining days off will appear. The absence temperature corresponds to the Antifreeze temperature. To change the temperature for your absence, press an arrow key in the status display. The Temperature-overview display appears. Change the absence temperature with the arrow keys and confirm with OK. To deactivate the holiday mode set "days absent" to "-" (not "0"). During holiday mode you can change the Antifreeze temperature in the Antifreeze menu, but this will not be applied for the current absence.

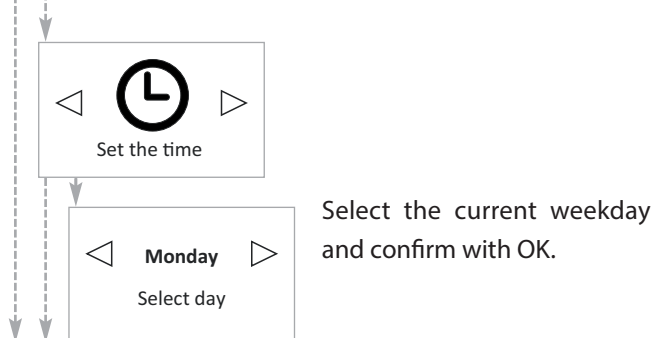

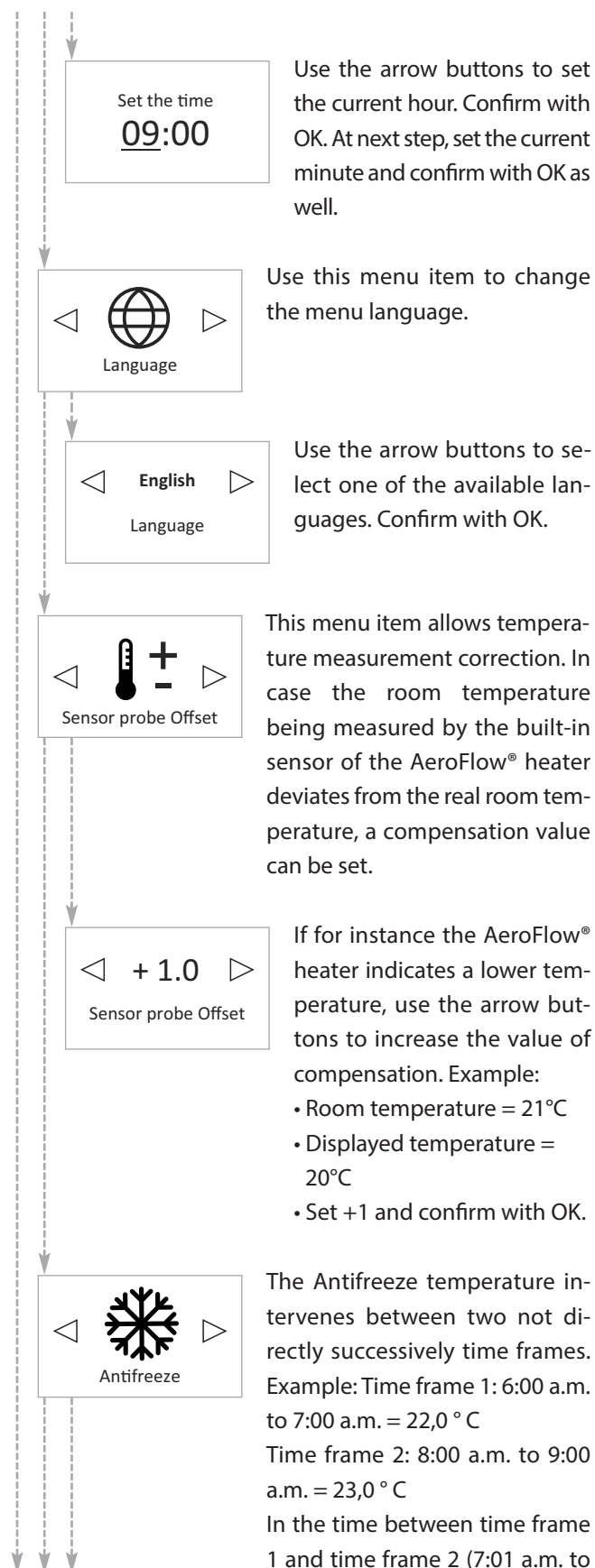

7:59 a.m.), the Antifreeze protection temperature is retained.



Select a Antifreeze temperature between 0 °C and 17 °C. Confirm with OK. The frost protection temperature can be changed manually at any time in the Temperature-overview display and is retained until the beginning of the next time frame. After the preset end time of the next time window, the Antifreeze temperature set in this menu is activated (and can be changed manually again).

Note:

If "Smart Start" is activated, the AeroFlow® radiator will start to heat already before the next time frame starts. If "Smart Start" is deactivated, the Antifreeze temperature is retained until the set start time.



Use this menu to connect the AeroFlow® heater to your smartphone or tablet.

Prerequisite: NetConnector (not included in standard AeroFlow® heater delivery)



In this menu you will find information about the device such as the software version.

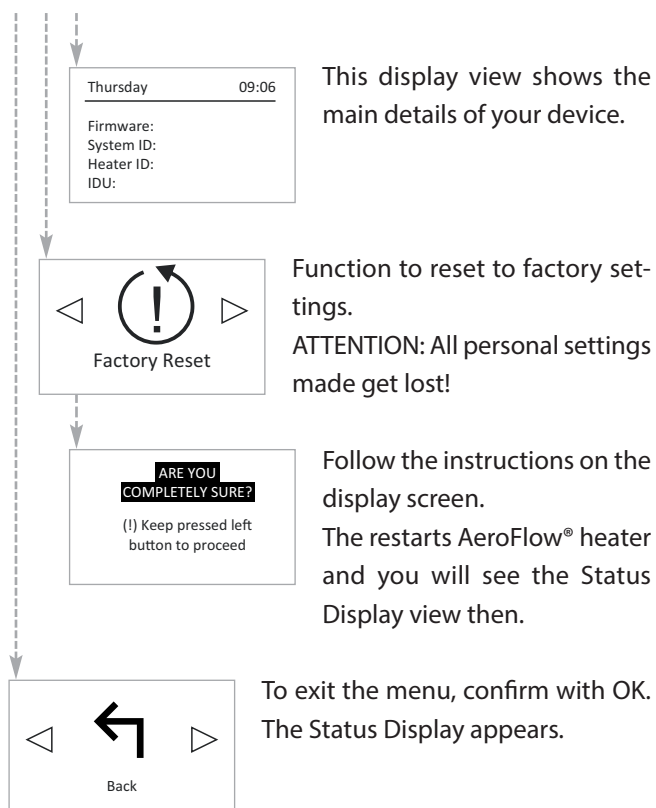

VYROBENO V NĚMECKU

Řada produktů AeroFlow® společnosti Thermotec AG je zárukou zdravého klimatu v místnosti a úsporného vytápění.

Naše dlouholeté práce na vývoji a moderní výrobní postupy jsou předpokladem pro dlouhou životnost a vysokou trvalou hodnotu Vašeho produktu AeroFlow®.

30letá záruka na výrobu tepla a provozuschopnost základní jednotky.

Nákupem tohoto zařízení jste se rozhodli pro inovativní kvalitní produkt absolutní špičkové třídy.

Děkujeme Vám za Vaši důvěru.

Sebastian Heidrich
Zakladatel a člen představenstva společnosti Thermotec AG

Garantie Zertifikat *warranty certificate*

Die AeroFlow®- Produktfamilie der Thermotec AG steht für ein gesundes Raumklima und kostenbewusstes Heizen. Unsere jahrelange Entwicklungsarbeit sowie ein modernes Produktionsverfahren sind die Voraussetzung für die Langlebigkeit und hohe Wertbeständigkeit Ihres AeroFlow®- Produktes.



30 Jahre Garantie auf die Wärmeerzeugung und die Bedienbarkeit des Grundgerätes

Mit dem Erwerb dieses Gerätes haben Sie sich für ein innovatives Qualitätsprodukt der absoluten Spitzenklasse entschieden.

Wir bedanken uns für Ihr Vertrauen.



Sebastian Heidrich
Gründer und Vorstand der Thermotec AG



Thermotec AG | Arnsdorf 26 | 02894 Vierkirchen | Deutschland
Phone: +49(0)3 58 27 78 93 30 | info@thermotec-ag.de

www.thermotec.ag